

DEVIATIONS FOR DIMENSIONS WITHOUT TOLERANCES		
WELDING ENISO 13920 grade: B	LIN. & ANG. TOL. ENISO 22768-1 grade: m	GEOMETRICAL TOL. ENISO 22768-2 grade: K

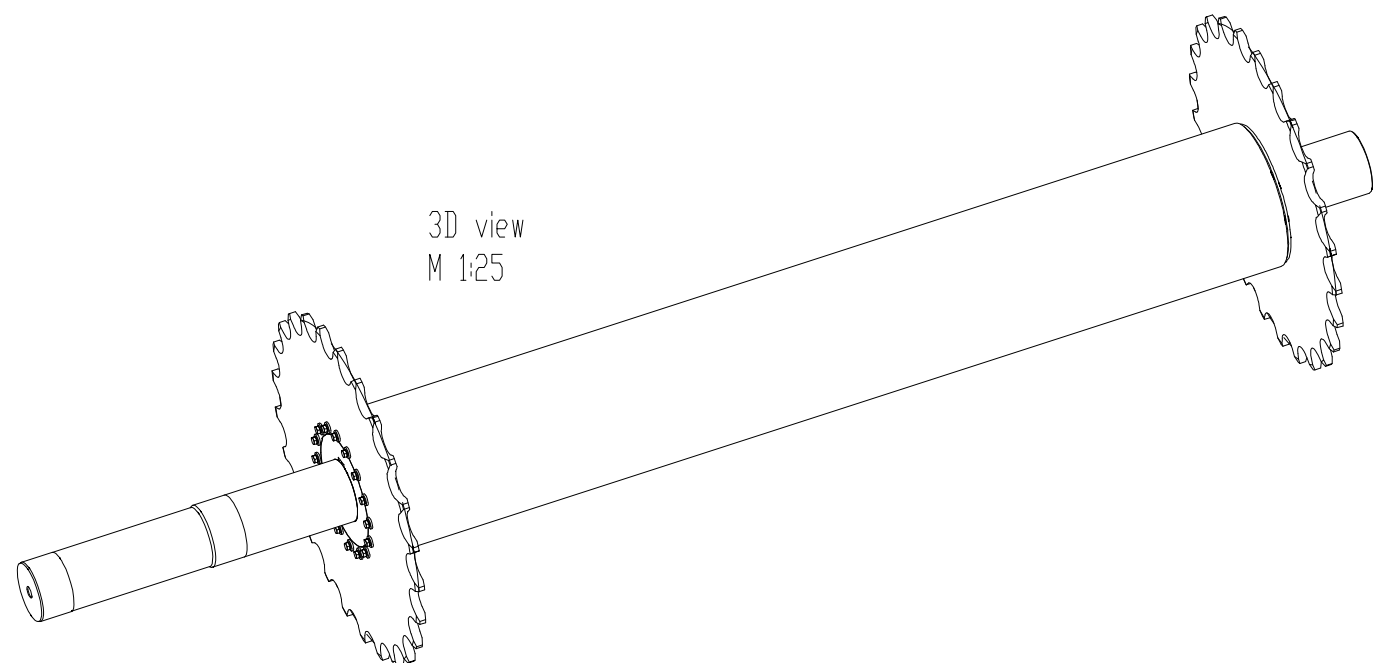
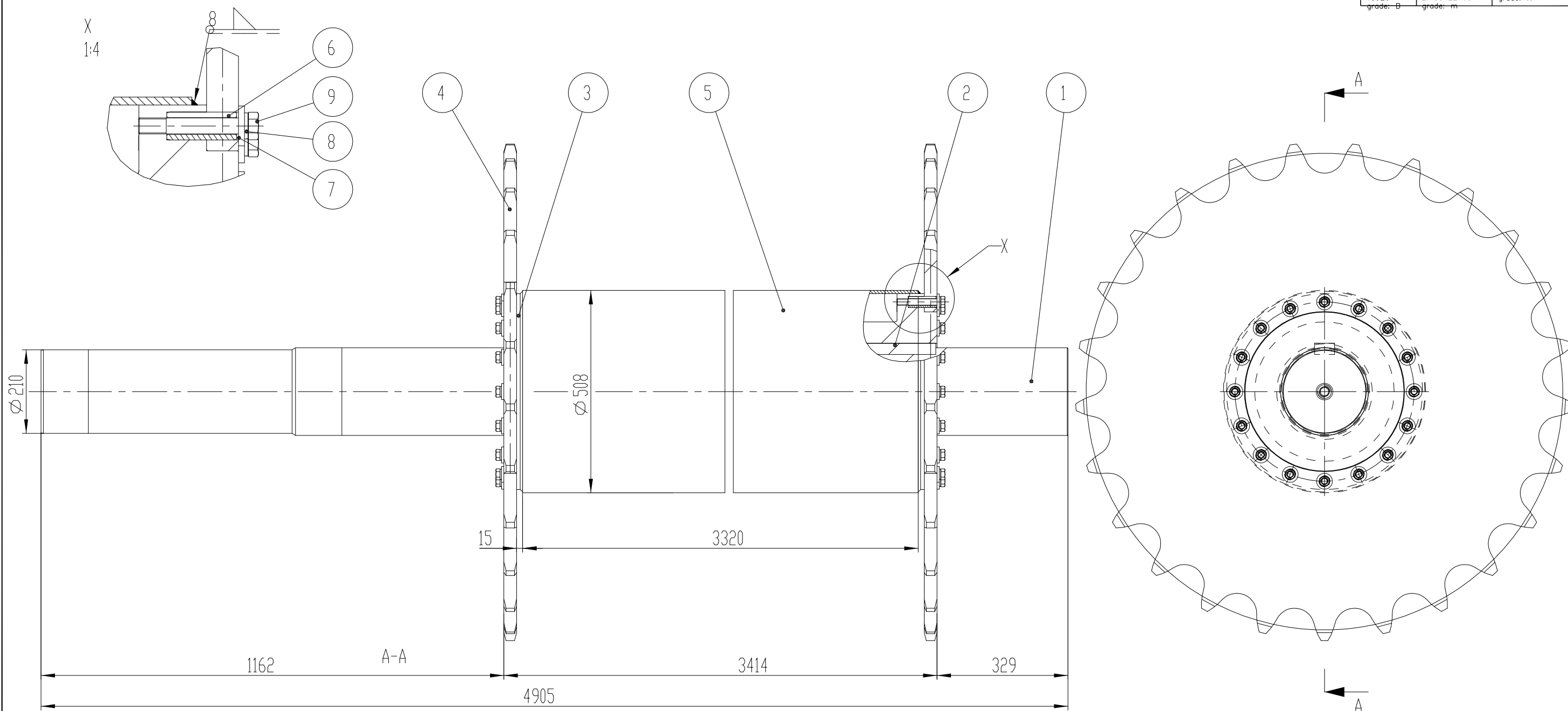

9	Hexagon head screw M16x110	32	DIN 931	12.9	0.2
8	Washer A16	32	DIN 127		0.0
7	Washer 17	32	DIN 7349		0.0
6	Grooved pin $\varnothing 28 \times 70 \text{mm}$	32	DIN 1481		0.2
5	$\varnothing 508 \times 8 \text{ L}=3320 \text{mm}$	1		St 37-3	327.5
4	Chain drive $z=25 \text{ L}=150$	2	CO-129-66		228.9
3	Hub	2	CO-539-66	St 37-3	144.3
2	Parallel key $50 \times 28 \times 190$	2	DIN 6885 A		2.0
1	Shaft	1	CO-229-66	42CrMo4	1615.4

Itemref	Title/Name, designation, dimension, etc	Quantity	Drawing No.	material	mass (kg)	Note
	Date			Mass (kg)		
	Designed by 30-May-07. Seleznev			2251.6		
	Checked by 30-May-08. Bazin			Sheet	1/1	
Scale	TITLE					
1:10	Shaft - structure					
				DRAWING_NUMBER	Edition	
				CO-429-66		

12.5 / 6.3 / 1.6

DEVIATIONS FOR DIMENSIONS WITHOUT TOLERANCES  
 WELDING LIN. & ANG. GEOMETRICAL TOL.  
 ENISO 13920 ENISO 22768-1 ENISO 22768-2  
 grade: B grade: m grade: H

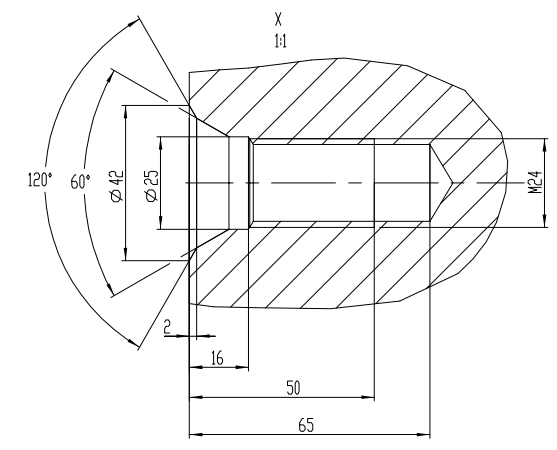
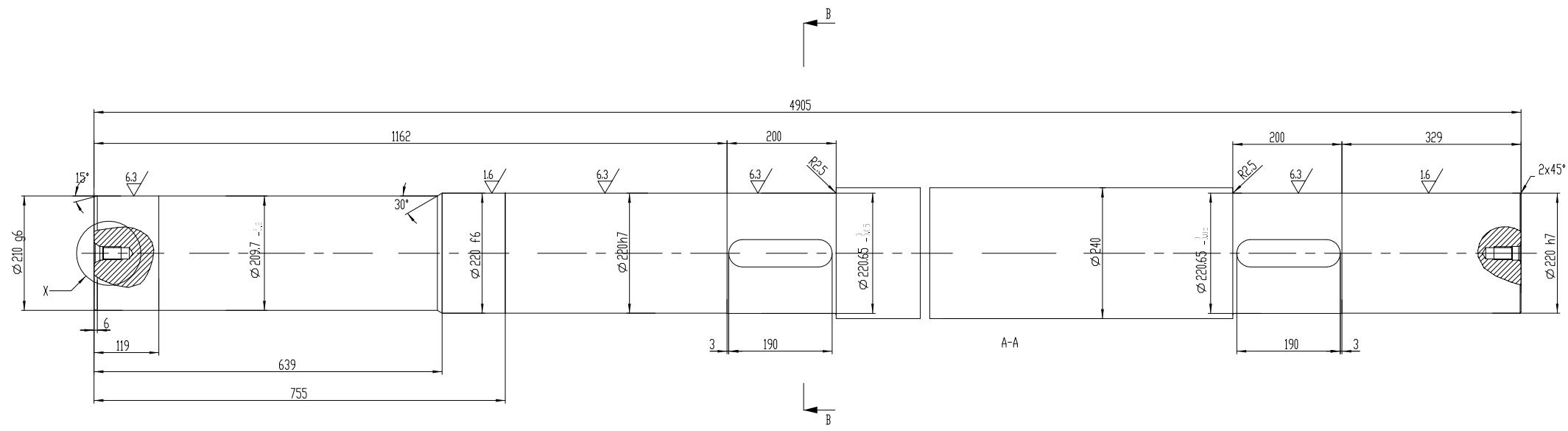
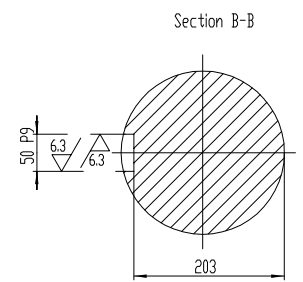

Heat treated to 800-1000 N/mm2

Ø240 L=4905mm		Quantity	Drawing No.	42CrMo4	1615.4	
Itemref	Title/Name, designation, dimension, etc.			material	mass (kg)	Note
	Date			Mass (kg)		
Designed by	30-May-07, Seleznev			1615.4		
Checked by	30-May-07, Bazin					
Scale	TITLE		Sheet	1/1		
1:5	Shaft					
		DRAWING_NUMBER	Edition			
		CO-229-66				